

# SQUARE FOOTAGE CALCULATIONS

## 26 Lone Pine Drive, Saluda

Approximate Total Finished/Heated Living Area:  
1780 Square Feet

First Floor: 1225 Square Feet  
Second Floor: 555 Square Feet

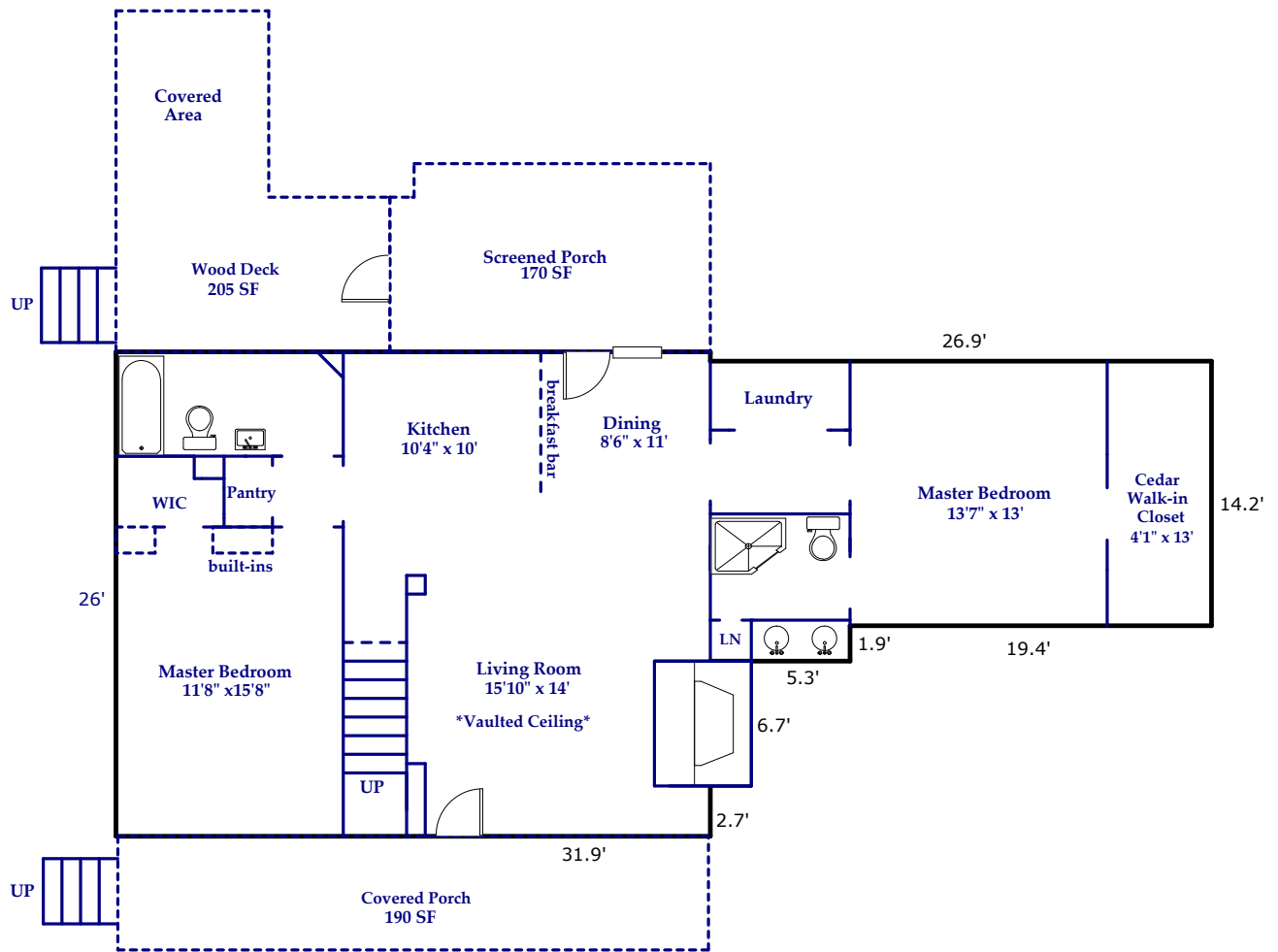

**FIRST FLOOR**  
1225 Square Feet

Prepared by Agent Services: Beverly-Hanks & Associates

Information herein deemed reliable, but not guaranteed. Floor plan for review purposes only. All dimensions approximate. Not for construction.

Scale: 1" = 15'

# SQUARE FOOTAGE CALCULATIONS

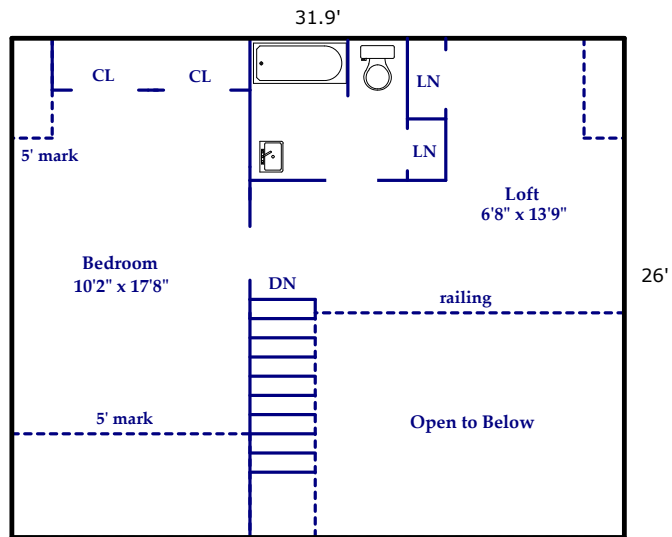

**SECOND FLOOR**  
555 Square Feet

# SQUARE FOOTAGE CALCULATIONS

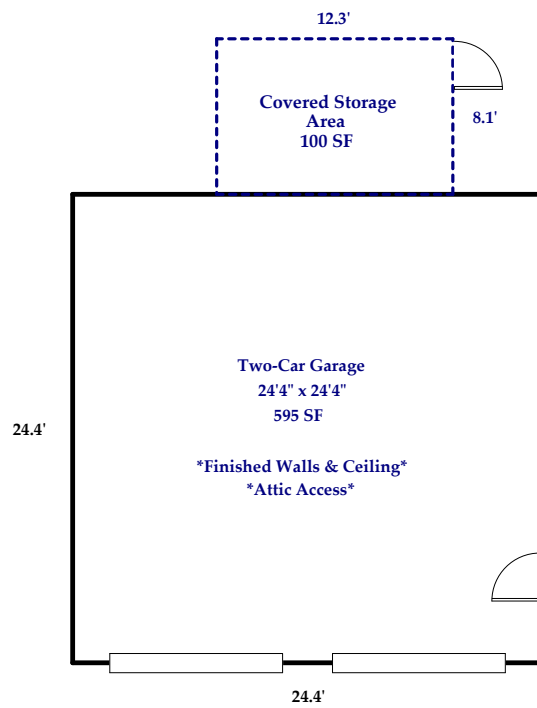

**DETACHED  
TWO CAR GARAGE**  
595 Square Feet