

*130 Stonebridge Drive, Hendersonville*

Approximate Total Finished/Heated Living Area:  
2985 Square Feet

First Floor: 1893 Square Feet  
Below Grade: 1092 Square Feet

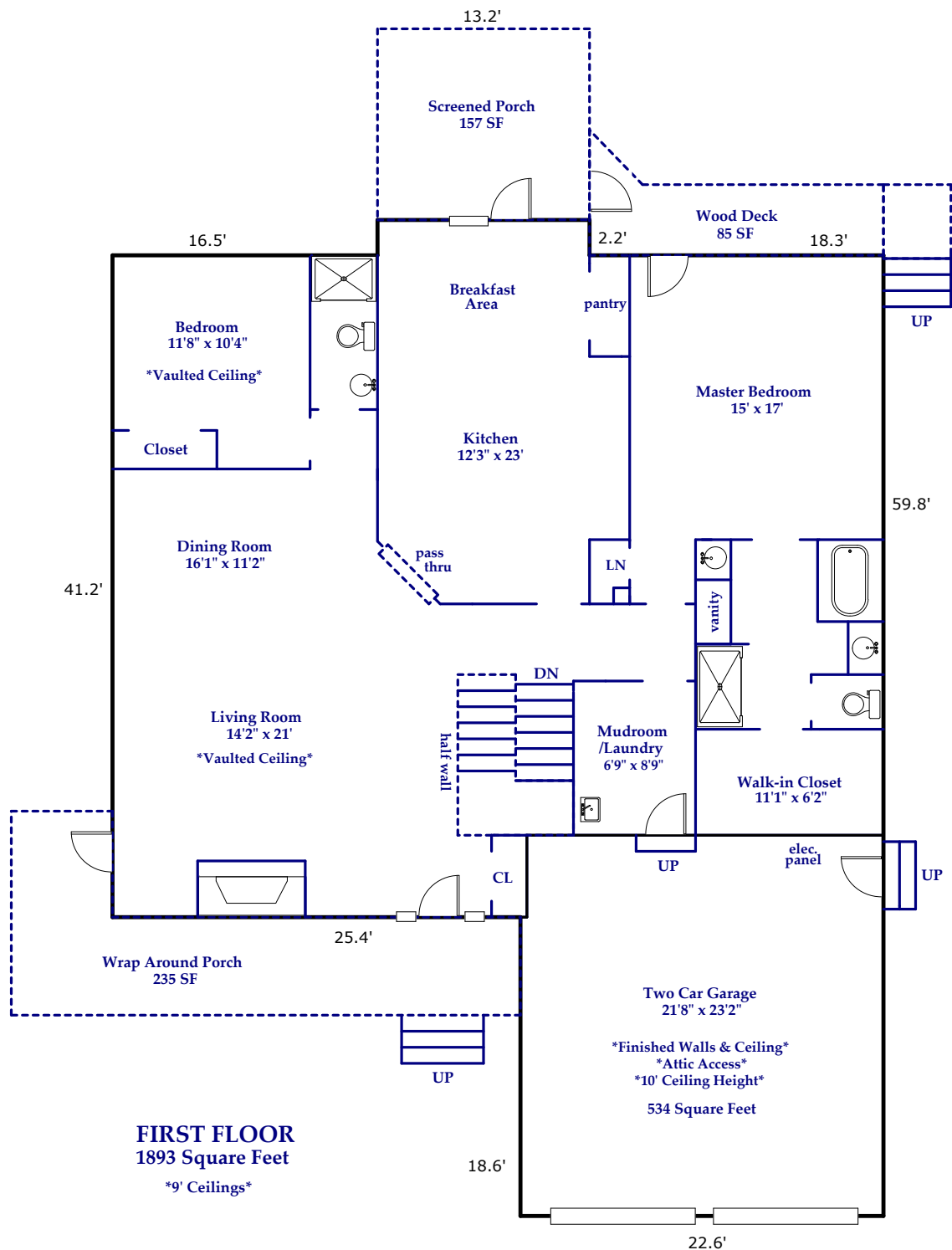

Prepared by Judy Brouillette-O'Neil: ProPlans of the Carolinas, LLC

All dimensions are rounded to the nearest .01 and are deemed reliable, but not guaranteed.  
Square Footage Calculations determined following ANSI Standards and NCREC House Measuring Square Footage Guidelines.

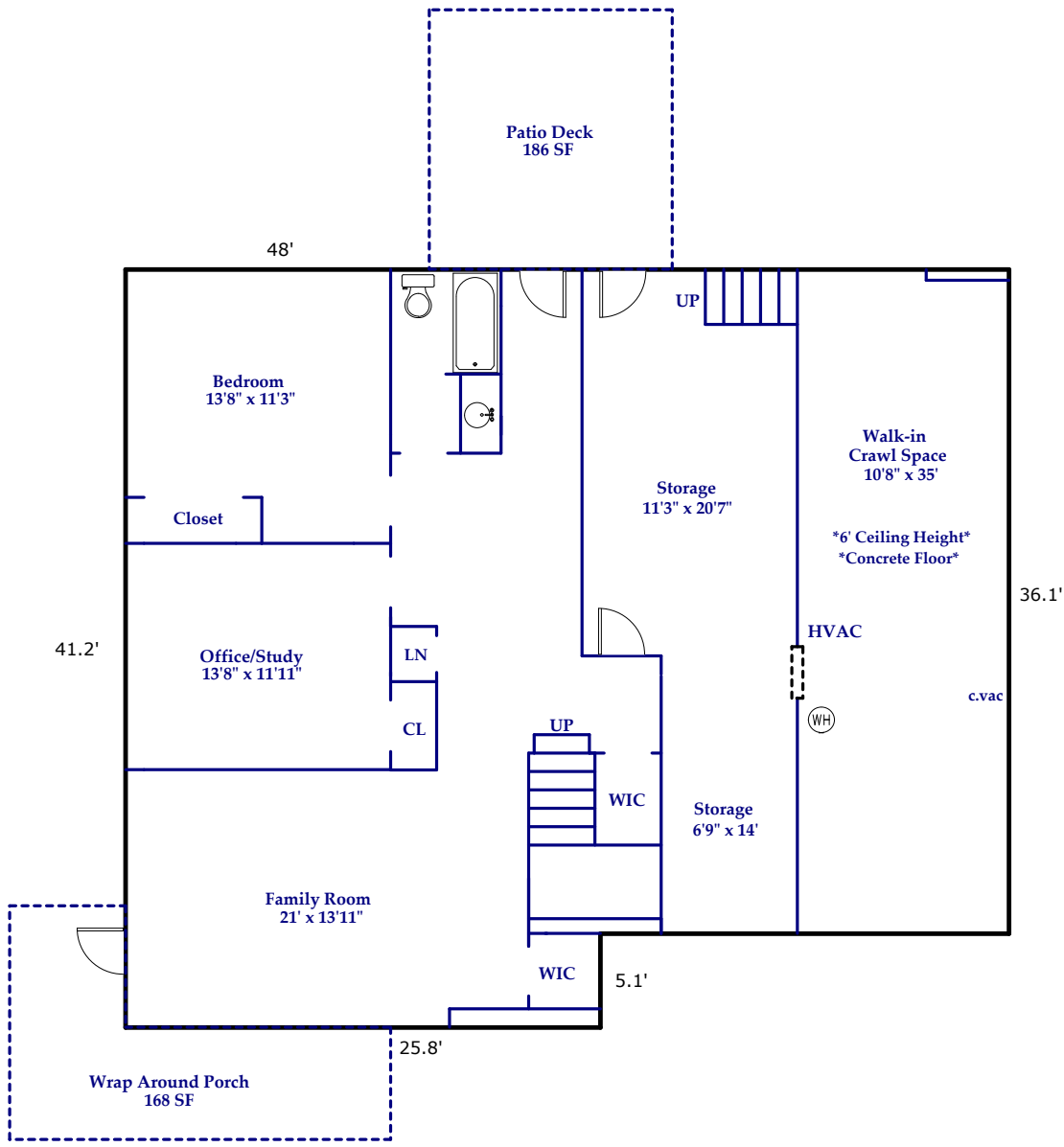

**BELOW GRADE**  
1450 Square Feet

Approximate Total Finished/Heated Living Area:  
1092 Square Feet  
\*9' Ceilings\*  
Unfinished Area: 358 Square Feet

**WALK-IN CRAWL SPACE**  
414 Square Feet

Total Square Footage Under Roof for All Finished/Unfinished & Heated/Unheated Areas:  
4034 Square Feet

\*Includes Screened Porch\*  
\*Does Not Include Walk-in Crawl Space\*